



Fire and Rescue Scrutiny Committee	
Report Title:	Update on progress with GFRS/Constabulary/ PCC/SWAST - Collaboration progress
Meeting Date:	Friday 26 May 2023 at 10.00 am
Chair:	Cllr Jeremy Hilton
Presenting Officer:	<i>Mike Hammond Head of Logistics and Resources GFRS</i>
Purpose of Report:	To update members on progress on the collaboration work with partnership agencies; Constabulary/ PCC/ SWAST
Planned Dates	N/A
Background documents:	N/A
Appendices	<i>Appendix 1 Plan of Newent Fire Station Appendix2 plan of Winchcombe Fire Station</i>
Recommendations	To note the content of the report

1. Background

A collaboration of partnership agencies have already been working together for a number of months. This is to aid ongoing dialogue for collaborative projects. The collaboration partners include

- The Office of Police Crime Commissioner (OPCC),
- Gloucestershire County Council (GCC),
- Gloucestershire Constabulary,
- Gloucestershire Fire and Rescue Service (GFRS)
- South West Ambulance Service Trust (SWAST)

The two groups that meet are the Collaboration Panel and Board.

1.1. The Collaboration Panel

The Collaboration Panel is attended by officers from across all partners who help facilitate the operation and implementation of ongoing projects as well as investigating other options for future projects. The outcome of this work is fed into the Collaboration Board.

1.2. The Collaboration Board

The Collaboration Board is made up of Strategic Officers from all of the partners, who will take decisions and set the direction for the Collaboration Panel to investigate projects across its estates.

2. Current Projects

2.1. The Newent and Winchcombe Fire Stations

The ongoing project at these two GFRS stations are well underway. The Police will soon take shared occupation of these sites alongside GFRS staff. We aim to achieve this by the end of May 2023. This date is slightly after the original proposed date of April 2023 due to the work needing to be undertaken prior to occupation. The plan of the shared facilities are laid out in Appendix 1 (Newent) and Appendix 2 (Winchcombe). The police will be funding all of the costs associated to the changes for these projects. Working with GCC Amps and Legal Services it has been formally agreed how they use the stations as well as the parking arrangements. Any further ongoing costs associated to these agreements have also been included.

2.2. Waterwells- GTEC Building

The project to move GFRS HQ from Waterwells GTEC building to GCC Quayside is starting to gain pace. There are ongoing discussions between GCC and the Police regarding the options around the future use of the second floor (Fire Floor) at Waterwells.

We have informed the staff at GFRS of the intention to move the HQ from Waterwells to Quayside. We have established a project board to assist with this. Engagement with staff will be to address any concerns or questions.

Even though the intension of this project is to relocate GFRS HQ, there will still be a presence remaining at Waterwells. The areas remaining at Waterwells are

- Fire Control
- ICT and
- Logistics and Resources.

These areas will remain at Waterwells as they are closely connected to the Police and our GCC Fleet functions.

The timescales for this project to end is hoped to be no later than September 2023, however we have to rely on third party suppliers to achieve this.

3. Conclusion

The Collaboration work within Gloucestershire has already achieved positive working arrangements across all partners involved. It will also continue to explore possibilities in the future to support better use of its assets in support of better working arrangements for its communities.

Appendix 1

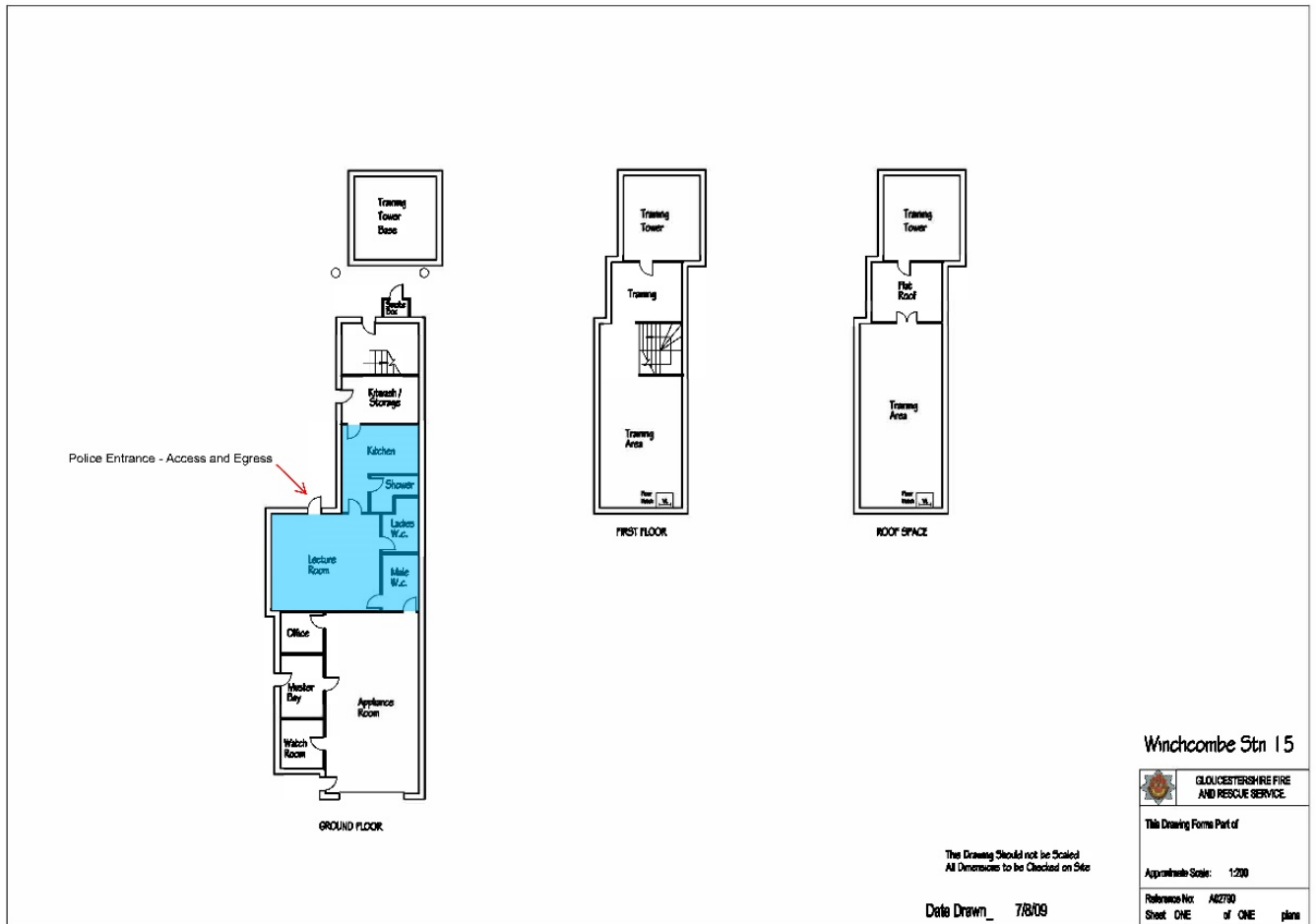

Appendix 2

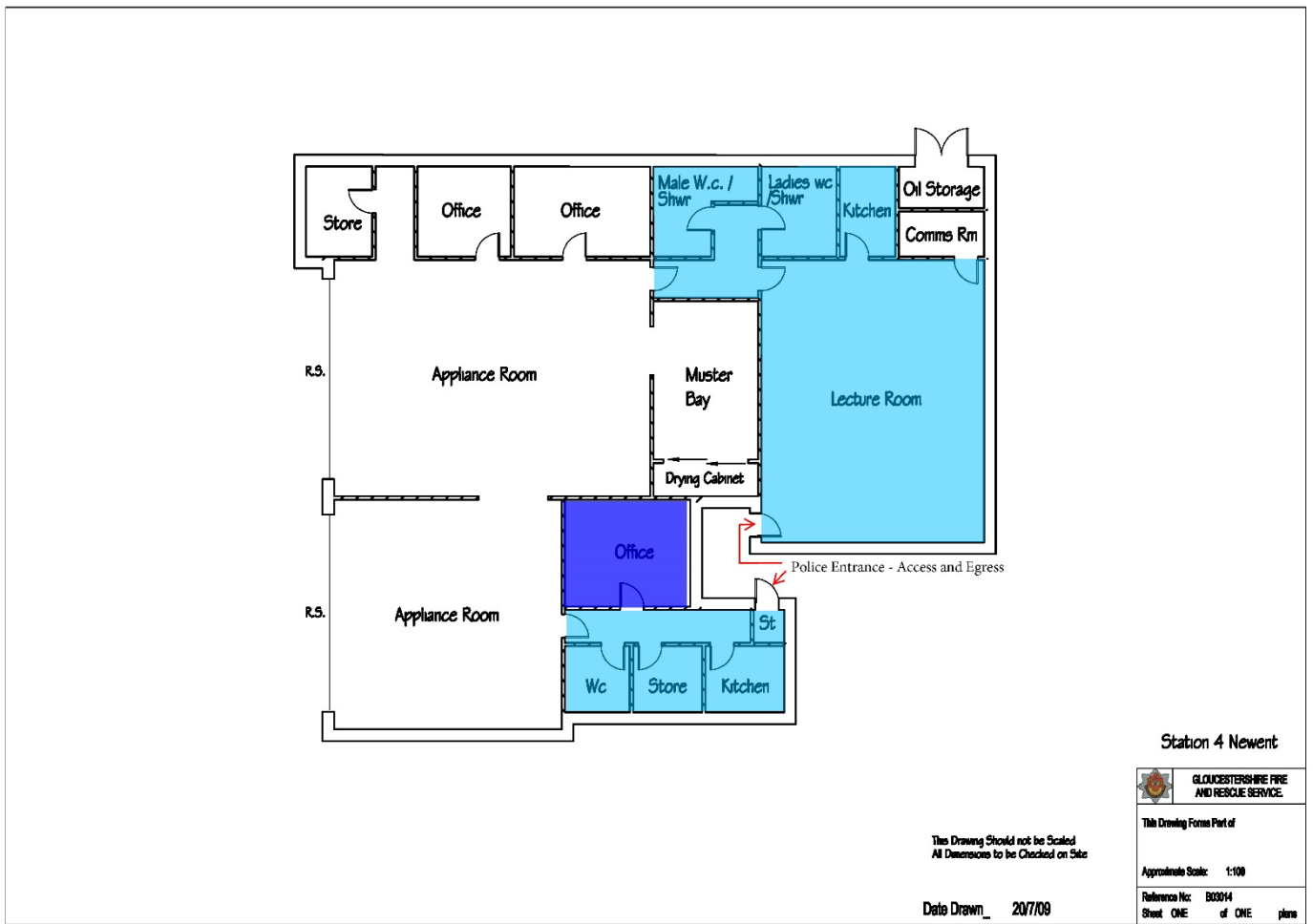

Station 4 Newent

	GLoucestershire FIRE AND RESCUE SERVICE
This Drawing Forms Part of	
Approximate Scale: 1:100	
Reference No: E00014	
Sheet ONE of ONE plans	

The Drawing Should not be Scaled
All Dimensions to be Checked on Site

Date Drawn_ 20/7/09