

MAP ANNEXED TO MODIFICATION ORDER APPLICATION
OR NOTICE TO LANDOWNER

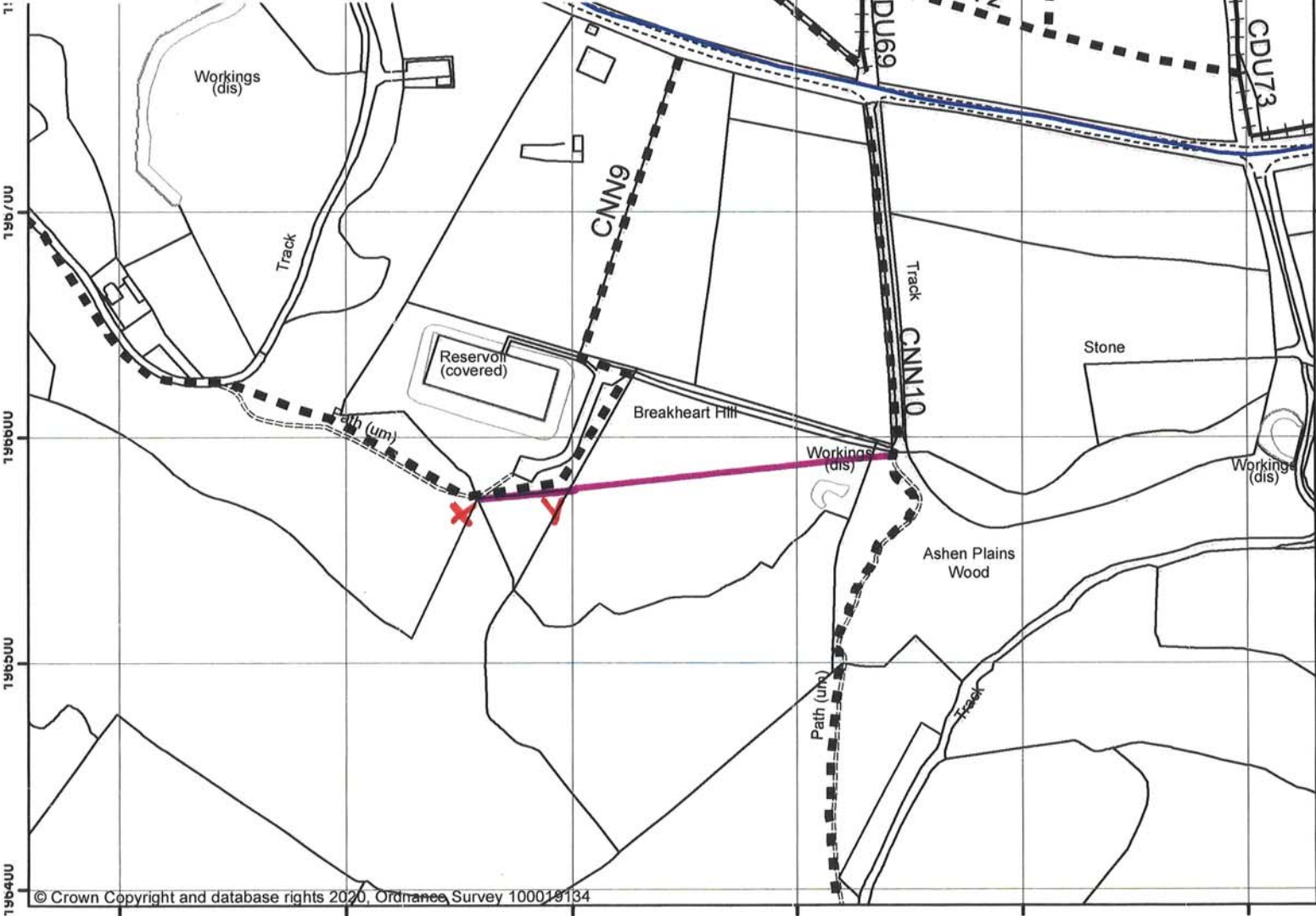

User's Initials:	Date:
	22/01/2020



JH2

**Claimed Path
Parish of
North Nibley**

**PLEASE MARK ON
THE MAP THE PATH
YOU WISH TO CLAIM
AND COMPLETE
THE KEY**

- KEY**
- Existing Public Footpaths 
 - Existing Public Bridleways 
 - Parish Boundary 

PLEASE COMPLETE :
Claimed path

Highway Records
Shire Hall
Westgate Street,
Gloucester, GL1 2TG
www.gloucestershire.gov.uk



DRAWN BY: J.W
SCALE: 1:2,500
DATE: 10-Jan-2020



This map is reproduced from (or based upon) Ordnance Survey material with the permission of Ordnance Survey on behalf of the controller of Her Majesty's Stationery Office.
© Crown Copyright and database right 2020, Ordnance Survey 100019134.
Unauthorised reproduction infringes Crown copyright and may lead to prosecution or civil proceedings. You are not permitted to copy, sub-license, distribute or sell any of this data to third parties in any form